

JBC

www.jbctools.com

INSTRUCTION MANUAL



Flexible Arm for FAE Fume Extractor

Ref. FAE020

Packing List

The following items are included:



**Flexible Arm for
FAE Fume Extractor** 1 unit
Ref. FAE020

Screws 3 units
Ref. 0019142



Manual 1 unit
Ref. 0019181

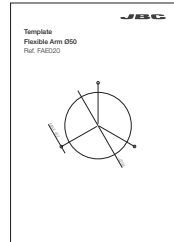

Annex 1 unit
Ref. 0020084

Assembly

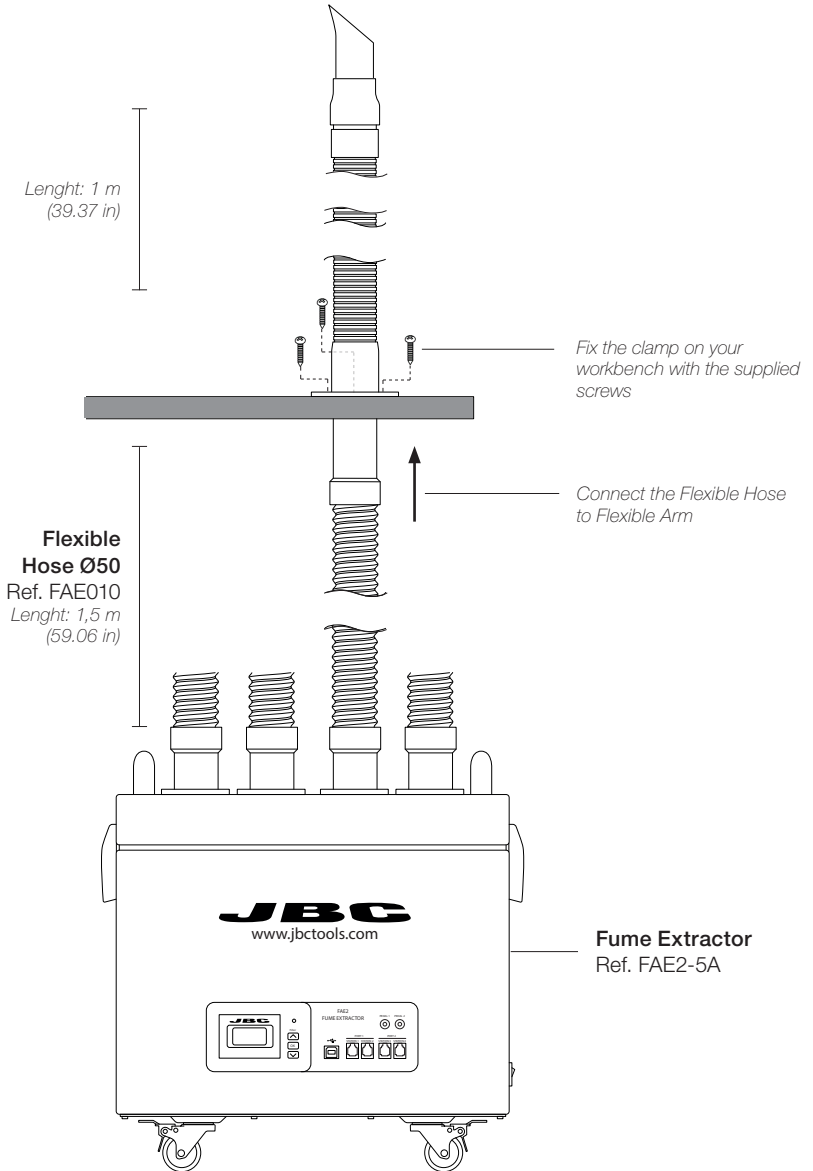

Arm assembly

- When the flexible arm loses firmness, it must be re-compressed.
- For a greater compression, turn it slightly clockwise.
- Once the arm is compressed, adapt its position again.

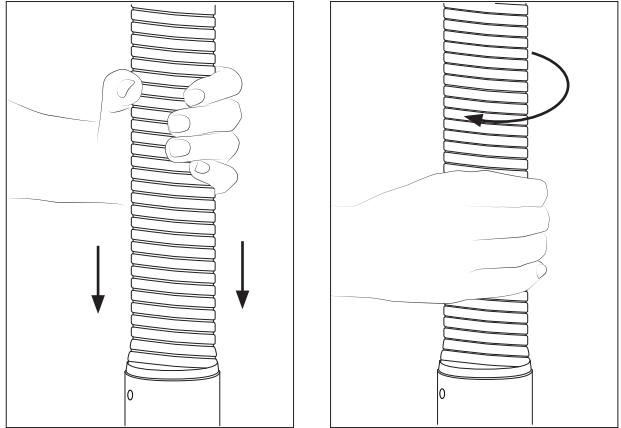

Nozzles

You can replace the supplied nozzle and choose the one that best suits your needs.



Rectangular Nozzle for FAE Fume Extractor
Ref. FAE080



Round Nozzle for FAE Fume Extractor
Ref. FAE081

Nozzle Replacement

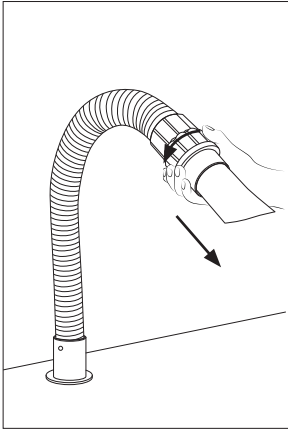

Turn the nozzle and pull out to remove it.

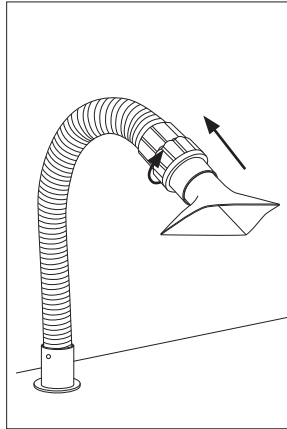

A bayonet fitting system allows a proper connection between the flexible arm and the nozzle.

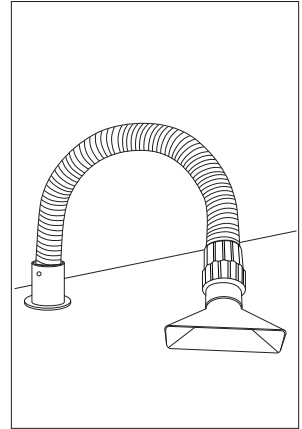

The nozzles are designed to work with the arm suspended and also supported on the work bench.

Installation Guide Line

To protect flexible arm tube from braking follows these installation guide lines.

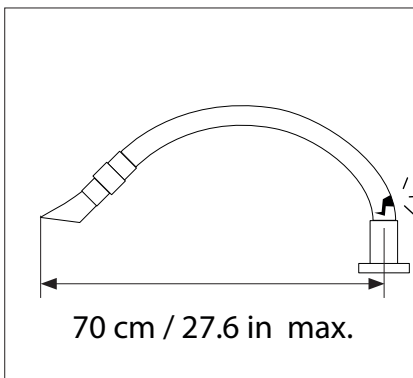

The recommended working area of the arm is 70 cm / 27.6 inches from the center of its base. Extending the arm more than this dimension could break it.

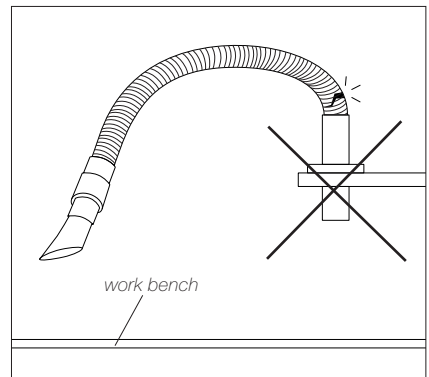

Do not install the flexible arm on shelves or higher levels than the work bench. Forced bending radii can cause arm breakage.

Specifications

- Weight: 1,75 kg (3.85lb)
- Length: 1 m (39.4 in)
- Inner Diameter: 50 mm (2 in)

- Total Package Dimensions / Weight: 1050 x 170 x 120 mm / 2.394 kg
(L x W x H) 41.34 x 6.7 x 4.72 / 5.28 lb

Complies with CE standards.
ESD protected.

JBC

Warranty

JBC's 2 year warranty covers this equipment against all manufacturing defects, including the replacement of defective parts and labour.

Warranty does not cover product wear or misuse.

In order for the warranty to be valid, equipment must be returned, postage paid, to the dealer where it was purchased.



This product should not be thrown in the garbage.

In accordance with the European directive 2012/19/EU, electronic equipment at the end of its life must be collected and returned to an authorized recycling facility.

